

# COMP SPL Show

**ST 35**

**100W**

## Technical Specifications

Component	High Efficiency Compression Driver	
Size	mm (in.)	35 (1.4)
Power handling	100	
W Peak	100	
W continuous	Hi-pass filtered @ 4,5 kHz - 12 dB Oct.	
Impedance	$\Omega$	4
Freq. response	Hz	2,5k ÷ 20k
Sensitivity	dB/SPL	109
Voice coil $\varnothing$	mm (in.)	35 (1.4)
Magnet	Neodymium	
Dome/Cone	Aluminium	
Weight of one component	kg (lb)	0,78 (1.7)

## Electro-Acoustic Parameters

D	mm	35
Xmax	mm	-
Re	$\Omega$	2,9
Fs	Hz	3200
Le	mH @ 1 kHz	-
Le	mH @ 10 kHz	-
Vas	l	-
Mms	g	-
Cms	mm/N	-
BL	T•m	-
Qts	-	-
Qes	-	-
Qms	-	-
Spl	dB	109



1. High magnetic permeability plates provide constant, even flux.
2. Neodymium magnet, for top SPL performance.
3. CCAR (Copper Clad Aluminium Ribbon) voice coil; for unheard-of thermal and mechanical capability.
4. Extralight aluminium membrane.
5. Anodized aluminium body; for maximum damping and vibration rejection.
6. High current, screw terminals.
7. High efficiency compression loading horn.

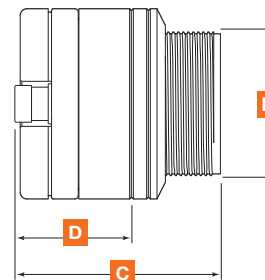
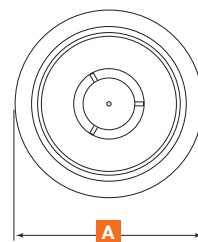
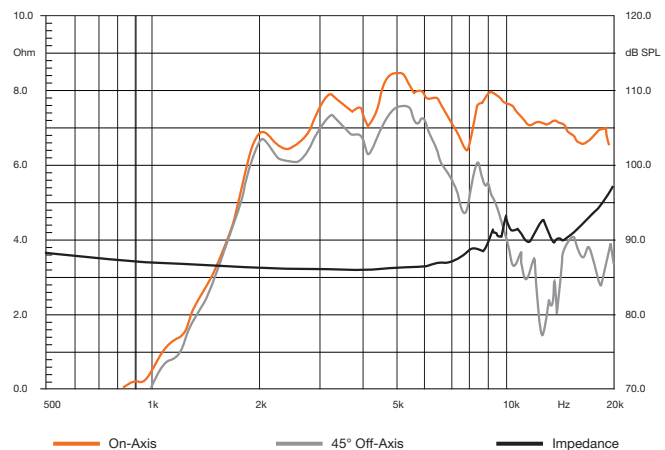

A	69,5 mm (2.8 in.)
B	51,5 mm (2 in.)
C	73 mm (2.9 in.)
D	41,5 mm (1.6 in.)